

NHS WALES ATHENS

From 8th July 2020 you will be able to use your NHS Wales email address and (Nadex) password to access online resources, without needing an OpenAthens username and password. If you do not have an NHS Wales email and password, you can continue to log in with your usual OpenAthens details. **Contact the library with any queries.**

How to sign in

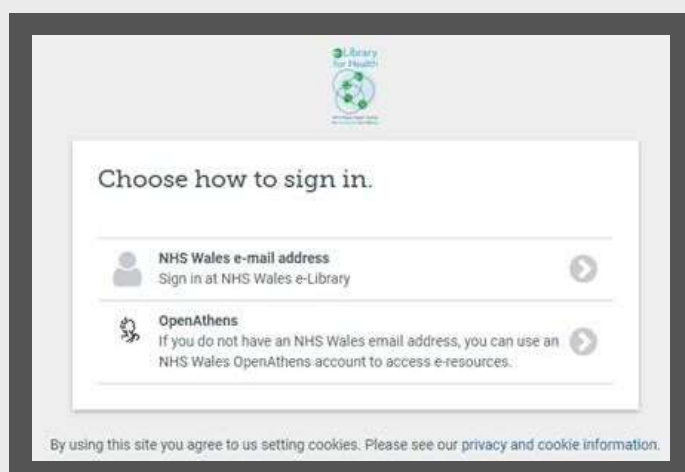

When you sign into an online resource you will see two options.

The new option **NHS Wales e-mail address** allows anyone with an NHS Wales e-mail address to sign in.

You can use the email address and (Nadex) password which you use to log-in to NHS Wales devices or systems.

Once logged in, you will be able to access all of the NHS Wales e-Library and local library e-resources without the need to log in again for the rest of the session, even off-site in all but a few isolated cases where resources are only available on the NHS Wales network, such as iRefer. If you do not have an NHS Wales email address, the **current OpenAthens** option will continue to work.

Existing Users - NHS Wales email access

If you have an NHS Wales Open Athens account you can continue to use it to login and access online resources through the Open Athens option. Alternatively you can use your NHS Wales email address and (Nadex) password. However please note that doing so will generate you a **new** OpenAthens account, and this might affect any personal accounts or settings in place.

Personalised accounts

OpenAthens accounts are linked to personalised accounts with BMJ and Elsevier. This means that those users who choose to change to the new method of access and have personalised accounts with any of the following resources from these suppliers (ClinicalKey, ClinicalKey Nursing, BMJ Best Practice, and BMJ Learning) will have to take some short steps to re-associate those accounts with the new log-in option, please contact the library for details.

New Users

Select the NHS Wales e-mail address option and enter your NHS Wales email address and (Nadex) password (as if you were logging into Office 365 / the NHS Wales network) to access the e-resources provided by the NHS Wales e-Library, or your local NHS Wales Library. To access full text journal articles or e-books you will also need to be a member of Velindre University NHS Trust Library.

Some users may not have an NHS Wales email address and they are still able to self register for an Open Athens account here:

<https://register.openathens.net/wales.nhs.uk/register>

