



**Canolfan Ganser Felindre
Velindre Cancer Centre**

A Velindre Cancer Centre for future generations

Our ambition to develop the greenest hospital in Britain

June 2020

Executive summary	3	Developing a green building	10	Turning our green commitments into reality	15
Introduction	4	Energy	10	Wellbeing of Future Generations	16
The site	5	Natural resources and materials	11	Advisors	18
Keeping the site green	6	Plant and machinery	12		
Community amenity	6	Water and drainage	12		
Biodiversity	7	Air quality	13		
Visual impact and landscaping	8	Light	13		
Transport	9	Noise	14		
		Waste	14		

EXECUTIVE SUMMARY

We want the new Velindre Cancer Centre to be the greenest hospital in Britain.

The new building will treat more patients and help more people live longer with cancer. When developing it, we will maintain and enhance biodiversity with healthy functioning ecosystems that support social, economic and ecological resilience and the capacity to adapt to change.

We will keep the Northern Meadows site green so we are committed to:

- Enhancing the community amenity enjoyed by local residents on the northern meadows site.
- Supporting the ecological diversity and natural environment of the site.
- Maintaining an accessible site, encouraging local residents to use the surrounding space, capturing the current existence of meandering pathways and the ability 'to lose oneself in the environment.'
- Supporting sustainable transport and a Green Travel Plan.

We also want the building to be green so we are also committed to:

- Minimising energy use and using renewable energy.
- Using natural resources, such as natural lighting, passive heating/cooling and natural ventilation, wherever possible.
- Reducing, or eliminating, expensive and complex mechanical plant and machinery wherever possible.
- Protecting and conserving water and reducing the need to control and/or treat storm-water run-off.
- Not having an adverse impact on air quality.
- Minimising light pollution.
- Minimising noise impact on our neighbours.
- Minimising the production of waste materials and managing them to minimise their impact on the environment.

We will deliver these commitments by giving a clear and ambitious brief to the consortia who bid for the contract to design and build the cancer centre. We will then use the procurement process so that, in order to win the contract, bidders must address our environmental requirements.

We are also required to have a number of plans agreed with the Cardiff City Council as part of our planning permission to make sure that we deliver against our commitments.

All of this is underpinned by our obligation to meet the ambition of the world-leading Well-being of Future Generations Act.



INTRODUCTION

We all know someone with cancer or someone who has had cancer. And the number of people diagnosed with cancer is increasing.

But Wales has some of the lowest cancer survival rates in the western world. And the 60 year-old Velindre Cancer Centre does not have the facilities or space to meet this future challenge.

So, we want to replace it with a new one.

The new Velindre Cancer Centre will treat more patients and help more people live longer with cancer.

Our vision is for a Velindre Cancer Centre which has the strength to last for the long-term, which promotes excellence in future cancer services and which exceeds the expectations of the future generations who use it.

Overall, it will need to improve the wellbeing of people – our patients, our staff and our neighbours.

It's a challenging vision and not one we can deliver in isolation. We will only be able to achieve it if we work with – and learn from - our neighbours, patients and staff.

We are committed to this engagement. We have also taken on independent advisers to guide us and to push us the extra mile.

This document explains how we will achieve our vision in relation to the environment.

It draws on the Design Brief we are developing for the new cancer centre and on the Green Infrastructure Plan we have agreed with the council. It also refers to *Our Wellbeing, Environmental and Architectural Vision for the new Velindre Cancer Centre and its Environs* written by our Consultant Design Adviser.

We set out here a series of commitments that start from the fact that nature has a healing and calming effect on people.

We are fully committed to delivering a building of the highest possible environmental and design quality and want our patients and the people of Wales to have the best that is possible.

Much of the site we have chosen will remain meadow land with open public access for walking, cycling and recreation to the retained and enhanced natural landscape.

We are committed to protect, retain and enhance local biodiversity with support from expert ecologists and community groups.

In short, we want the new Velindre Cancer Centre to be the greenest hospital in Britain.



THE SITE

The site of the new Velindre Cancer Centre occupies part of what is known as the northern meadows.

The land was formerly used as a farm to grow food for residents of the self-sufficient Cardiff City Mental Hospital, as Whitchurch Hospital was then known.

Still owned by the NHS, in recent years the site has been allowed to grow wild.

In 2001 the Welsh Government decided a planning appeal in favour of allowing a mixed use development of the whole Whitchurch Hospital site, including housing on the northern meadows. Cardiff City Council has renewed this outline planning permission several times since then, having considered objections on environmental grounds.

The principle of development is therefore well established. The choice is housing or a new cancer centre.

Velindre University NHS Trust selected the site after reviewing other potential options in the wider NHS estate. We identified potential sites at Llanfrechfa Grange, north of Newport, land opposite the Royal Gwent Hospital in Newport and land adjoining the University Hospital of Wales (UHW) in Cardiff. At that time, our aim was to construct the hospital in 2021/2022 and these sites did not provide what we needed. The Newport sites were not geographically suitable because the majority of our patients live in the Cwm Taf Morganwg and Cardiff areas. The site near UHW was too small for our needs.

We also reviewed the possibility of building on the current Whitchurch Hospital but this was too small to construct the cancer centre to the required standards. The whole building is also listed with some important historical features so it would be difficult to develop.

Land to the south west of Whitchurch Hospital has outline planning permission for a hospital but is too small.

We also considered another site next to Whitchurch Hospital but it wasn't big enough.

We undertook a brief review of the position in 2017 and the NHS owned land at the

northern meadows remained the preferred site. It offers access for patients off the M4 and A470. It had planning permission granted on it previously. It is owned by the NHS and it worked for our timescales at the time for construction of the cancer centre.

Velindre University NHS Trust was granted outline planning permission to build the new Velindre Cancer Centre in 2018.

If we did not build the new cancer centre on the northern meadows site we would lose two more years and the money it costs to find a new site and develop plans for it. We would face the uncertainty of applying for planning permission and negotiating acceptable land agreements. More importantly, the current site does not meet modern hospital standards and there's no space for development. Over a further two years, our current services, site and equipment would be stretched beyond what they can cope with. People with cancer would feel the consequences.

The planning application was granted after enactment of the Well-being of Future Generations (Wales) Act in 2015 and the Environment (Wales) Act in 2016 so it complies with both.

One of the major benefits of the site for Velindre is its location, providing patients with a much better, more peaceful and restorative healing environment in which to be treated.

Under our current planning permission, 60 per cent of the site will remain undeveloped taking into account roads and car parking as well as the building itself.

The development will not interfere with the Site of Special Scientific Interest (SSSI). We are required to retain, create and enhance a buffer zone of at least 15 metres width along the edge of the Glamorgan Canal nature reserve / Long Wood SSSI. The buffer zone will be free from all built development including lighting, gardens and formal landscaping.

We are required to produce a plan showing the extent and layout of the buffer zone with details of proposed planting, only using local native species; how existing vegetation will be managed; and how it will be protected both during construction and over the longer term.

Community amenity

We are committed to enhancing the community amenity enjoyed by local residents on the northern meadows site alongside the new cancer centre.

As well as improving access to the landscape of the northern meadows, there will be no changes to existing public rights of way and permitted paths to link residents on the Hollybush Estate and Park Road with the Glamorganshire Canal, Forest Farm and the Taff Trail. The land to the south of the public right of way besides the cricket pitch and bowls club is identified as a wildlife corridor.

More than this, we are committed to improving footways and cycle paths through the site to encourage use of the site by the community.

When we were granted planning permission for the new cancer centre, we agreed to give Cardiff City Council £400,000 to improve the gates, pathways and information signs in the Forest Farm country park area. We also agreed to treat invasive species in the area.

The money could also be used by the council to upgrade the open recreational areas at Radyr Weir and by the Glamorganshire Canal, including the historic features of the canal.

Inevitably, during construction, there will be some temporary loss of amenity. However, it will still be possible for walkers and cyclists to travel north to south along the designated public right of way.

They will also be able to use the existing footbridge next to the Lady Cory Field gate with only very temporary construction traffic regulation at entrance points. There will be unrestricted general access further west beyond the site in the northern meadows connecting the nature reserve to Longwood Drive over the existing foot bridge. The nature reserve woodland path at the top of the embankment, outside the site, will remain open access.

There will also be some temporary safety fencing and restricted public access to the railway cutting during the preparation for, and construction of, the two access bridges. Prior notice will be given with clear directions to alternative routes.

When we finish the different construction phases we will replant and make good all the land we are no longer using, including the old railway cutting and Lady Cory's Field.

We will also leave the entrance to Whitchurch Hospital in a better state than it is now by repairing the gate posts and by improving the sight lines and poorly laid out pedestrian crossing.

Biodiversity

We are committed to build a new Velindre Cancer Centre which supports the ecological diversity and natural environment of the site.

Through landscape design and protection measures, we want to support the ecologically valuable flora and fauna in the local area as well as protect the surrounding Site of Special Scientific Interest.

These requirements apply during the course of the works and throughout the building's operational life.

Following the granting of outline planning permission for the new Velindre Cancer Centre, Cardiff City Council requires us to submit final design proposals for the retention, creation, enhancement and management and maintenance of ecosystems and their constituent habitats.

Our plans will cover woodland, hedgerows and trees, grasslands and drainage, highway trees and verges. They will also cover other habitats providing foraging, commuting, sheltering and breeding opportunities for wildlife. We will describe the habitats and their desired condition as well as key indicators to show when the desired condition has been achieved and how we will manage them.

We will use these plans to identify, support and monitor protected species including badgers, bats, dormice, birds and reptiles. We will time works to avoid disturbing their habitats during sensitive breeding or hibernation seasons and will ensure there are alternative habitats available for them to use at all times.

We will not disturb the heronry to the north of the site at all.

On a similar basis, we are updating our surveys of the trees which are likely to be affected by the development and we are committed to replacing any tree that we have to remove with two new ones.

Finally, our plans will include action to eradicate any invasive non-native species that we find on the site.

These commitments cover mitigation of any impact caused by the new Velindre Cancer Centre. We are also committed to mitigating any impact to the ecology of the site which may be caused by our construction activity.

We are required to explain the action we will take to protect the habitats and protected species, trees, landscape, soil, open space and drainage resource during clearance and construction.

Our plans will assess the environmental impacts and show what will be lost, retained, enhanced, moved and newly created.

They will cover pre-construction checks, details of site clearance and construction methods, the phasing and timing of works.

Specialist ecologists and landscape designers will work with us to assist with all the above.

Visual impact and landscaping

We are committed to a new Velindre Cancer Centre which is accessible, encouraging local residents to use the surrounding space, capturing the current existence of meandering pathways and the ability 'to lose oneself in the environment.'

We will ask our bidders to design a building which sits comfortably in the landscape without dominating it. We will encourage the use of green roofs, living walls of plants and natural planting screens to help minimise the building's impact.

The new building will be no higher than the trees bordering the site.

As part of our planning permission we are required to agree a landscaping implementation programme with the council.

This plan will cover planting plans prepared by a qualified landscape architect, proposed finished levels, earthworks, hard surfacing materials and existing and proposed services and drainage above and below ground level.

During the construction phase, we are required to agree a plan to detail site hoardings - including their erection, maintenance, security and any decoration - and means of enclosure to prevent unauthorised access during construction. We want to work with local artists and schools so that the hoardings are stimulating and attractive.



PHOTO CREDIT - DOWN TO EARTH

Transport

We are committed to supporting sustainable transport and a Green Travel Plan.

We want to integrate public transport links with the new Velindre Cancer Centre site, linking with the council's plans for improved railway, bus and park and ride facilities.

The site is a short walk from Coryton railway station and we support plans to extend the Metro line from Coryton down the currently disused railway cutting with a new station bordering the site.

We also want to work with Cardiff Bus to introduce a bus service to the front door of the new building. When Cardiff City Council granted us planning permission for the new cancer centre, we agreed to give the council £450,000 to subsidise a direct bus service between the city and the new cancer centre.

One of the benefits of the site – and a reason for selecting it – was that cars can enter it from the M4 and A470 without needing to travel to Whitchurch down Pendwyallt Road and Park Road. Three quarters of our patients and staff travel from this direction so, when built, there will be a significant reduction in road traffic in Whitchurch associated with Velindre.

We are committed to providing charging points for people who drive to the site in electric cars.

We are also want to provide facilities to encourage active travel. As part of our planning agreement with Cardiff City Council, we are committed to a Green Travel Plan, promoting cycling and walking to work and reducing single occupancy car use.

The plan includes the provision of facilities for cyclists, such as covered, secure bicycle shelters and shower and changing facilities, safe walking routes, on-site bus stops and new bus links with the city centre. It also includes promotional steps such as a cycle purchase scheme for staff and designated car-parking for car sharers.

We want to link the site with the Taff Trail to support staff cycling to work.

The new Green Travel Plan is stronger than Velindre's current practice. The key new measures will be the employment of a dedicated travel plan manager and parking management.

There will be ample car parking spaces on the new site and we want to work with local residents and the council to prevent staff and patients who travel from the south parking in neighbouring residential streets.

The coronavirus pandemic has given impetus to remote working by staff and online consultations with patients. We want to develop these ways of working to reduce our transport demands.

During the period when we are building the site, construction traffic will be governed by strictly controlled management plans we have to agree with the council.

These plans will limit site access, employee parking (to be within the main body of the site) and action to reduce dust such as the dampening of temporary construction roads.

Independent transport experts have shown us that Park Road, between Whitchurch Hospital and the Coryton roundabout, has the vehicular capacity to take the additional construction traffic.

At the moment around 14,800 vehicles use Park Road every day. Of this, around 1,100 are heavy goods vehicles. Our plans will typically add 100 lorries a day. Often this will be less.

So that we don't interfere with the school run, the lorries will not use Park Road during school opening and closing times - between 8am and 9.15am and between 3.15pm and 4pm on Mondays to Fridays.

They will also not use Park Road on Saturday afternoons and Sundays.

The numbers and time periods will need to be acceptable to Cardiff City Council in terms of safety, traffic and environmental impact.

Energy

We are committed to a new Velindre Cancer Centre which minimises energy use and uses renewable energy.

We want an energy efficient building that reduces the on-going demands on fossil fuel. Our ambition is to be carbon neutral.

The overall design principle should be 'fabric first.' This means that we should orientate the highly insulated building and use glass for daylight and solar radiation. It also means that we should provide shade from the sun to prevent overheating, and passive ventilation to avoid an over-reliance on air conditioning and fans.

Such a design should minimise reliance on complex technologies requiring long-term maintenance and energy use.

We want to take advantage of opportunities for on-site energy generation. This should be an integrated part of the design to provide resilient services for the heating, cooling and power demands of the site.

We will ask our designers to consider green technologies such as:

- Solar photo voltaic panels to generate electricity and solar heating panels to heat water
- Combined Heat and Power systems
- Ground source heating
- Using the benefits of passive solar gains whilst controlling and avoiding overheating

We have laid down minimum standards of energy efficient design. This includes achieving BREEAM Excellent – the world's leading sustainability assessment – as a minimum for energy performance. However, our aspiration is to be BREEAM Outstanding.

Evaluation points will be awarded for this as part of the criteria for selecting the successful contractor. We want bidders to provide a design that reaches the minimum energy use at least. Those who commit to exceed it will be credited.

We will specify a comprehensive system of measurement and the role of an Independent Assessor to monitor and report energy use. Contractors will be rewarded if they perform better than promised and we will reduce payments if they fail to reach their agreed energy target.

Natural resources and materials

We are committed to use natural resources, such as natural lighting, passive heating/cooling and natural ventilation, in the new Velindre Cancer Centre wherever possible.

We want to minimise the environmental impact of materials used in the new centre over their lifetime – including their production, maintenance and disposal.

Soils will be protected in accordance with a soil management plan. We do not intend to import soil to the site. Soils will be reused on site which will ensure the natural seed bank is retained.

We will require our contractors to focus on the use of non-toxic, low carbon, breathable building materials and construction practices.

The cancer centre should achieve an integrated and intelligent use of materials that maximises their value. It should prevent 'downstream' pollution from the extraction, manufacture and transport of materials. And it should also prevent 'upstream' pollution from their impact when used, and from demolition, disposal or recycling. It should also conserve resources.

In the choice of all materials we want their embodied energy, and the ability to recycle them at the end of their use, to be a major consideration.

We want to design and operate the building so that it uses and reuses materials in the most productive and sustainable way across its entire life cycle. It should be adaptable for reuse during its lifetime.

The environmental impact - global warming, resource depletion and toxicity – of materials used in the building should be minimal.

The use of environmentally preferable materials should reduce the impact on human health and the environment. It should contribute to improved patient and worker safety and health, reduced liabilities and reduced disposal costs.

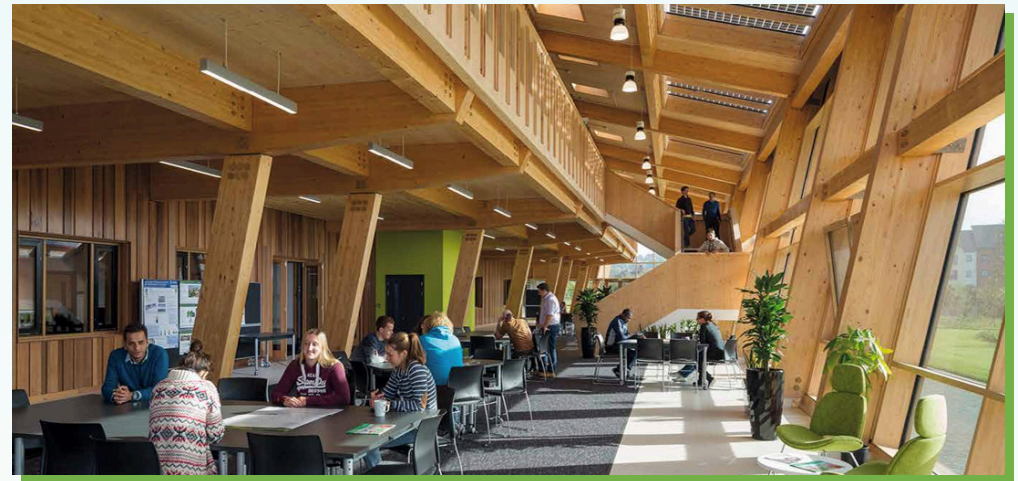

Plant and machinery

We are committed to a new Velindre Cancer Centre which reduces, or eliminates, expensive and complex mechanical plant and machinery wherever possible.

By minimising complex mechanical approaches, using systems that are easy and cost-effective to maintain and by building in meters to monitor the efficient use of energy and water, we can reduce our environmental impact.

The use of passive or controlled ventilation and the provision of solar shading is another example of how this can be achieved.

For the construction of the new cancer centre, we are required to agree plans with the council for the storage of plant and materials (including any oils, fuels and chemicals), construction compounds and any temporary facilities for construction staff.

We are also required to take action to control cement-based materials.

Water and drainage

We are committed to a new Velindre Cancer Centre which protects and conserves water and which reduces the need to control and/or treat storm-water run-off.

New buildings fundamentally change the ecological and hydrological function of undeveloped land so we want a design which minimises the impervious cover created.

We also want the building to use water efficiently, providing potable water to outlets that will be used by immunocompromised patients.

We will do all we can to make sure that the risk of flooding is not increased by construction of the new centre.

Specifically, since January 2019, new developments covering more than 100m² are required to provide sustainable drainage. Surface water drainage systems must be designed and built in accordance with mandatory standards for sustainable drainage published by the Welsh Government.

Our drainage proposals for the new site will need to be approved by Cardiff City Council acting in its role as the Sustainable Drainage Systems (SuDS) Approving Body.

Our commitment to sustainable drainage applies to the construction works as well. We are required by the council to show how surface water and land drainage run-

Air quality

We are committed to a new Velindre Cancer Centre which does not have an adverse impact on air quality.

By planting new trees and by using green walls, roofs and enhanced landscaping we will reduce air pollution.

We have conducted an air quality impact assessment of our plans, modelling emissions of oxides of nitrogen and particulate matter associated with our projected onsite energy use as well as traffic travelling to and from the cancer centre. This shows that the impact will be negligible.

For the construction period, we have updated the environmental impact assessment we originally submitted. The report shows that, even when applying a three-fold safety factor to anticipated peak construction traffic, pollutant levels are well within the national air quality standards. Any impact would be “negligible” and temporary.

We will also be required to agree a plan with the council which governs dust management during construction. It will explain the action our contractors must take to control the emissions of dust and to minimise sediment loading.



Light

We are committed to a new Velindre Cancer Centre which minimises light pollution.

Externally, we want to use movement sensors to activate light gradually from low levels so that people using the site feel secure but without disturbing wildlife.

We want to improve lighting for pedestrian and cycling access to the site to encourage active travel and recreational use of the land.

During the construction phase, we are required to agree a plan with the council which controls light spillage to wildlife corridors and habitats.

The scheme will include details of the siting and type of lighting to be used, measures to control light spillage, drawings setting out light spillage in key areas for wildlife, measures to monitor light intensity and remedial action to be undertaken where problems are identified.

Noise

We are committed to a new Velindre Cancer Centre which minimises noise impact on our neighbours.

We want to use landscaping with appropriate planting and screening to reduce noise and maintain the peace which people value about the site.

We also want to reduce traffic noise by setting strict speed limits; and to reduce the noise of mechanical and electrical services by using acoustic screening and by replacing them with passive ventilation and renewable energy.

During the construction phase, we are required to agree a plan with the council to control and monitor noise.

Construction hours will be strictly controlled. There will be no Sunday works.

Noise and vibration levels will be limited by planning conditions and will be enforceable under the contracts. We will hold regular monthly contract meetings to monitor compliance.

Where new fixed plant is required, we will choose low noise options designed to minimise noise wherever possible.

Waste

We are committed to a new Velindre Cancer Centre which minimises the production of waste materials and which manages them to minimise their impact on the environment.

Our commitment to reduce waste applies to the construction works as well. We are required to develop a Site Waste Management Plan for the recycling and/ or disposal of all waste resulting from construction works.

We are committed to build a new Velindre Cancer Centre which leads the world in sustainable design.

There are a number of ways in which we will make our powerful vision a reality.

We are developing a Design Brief which explains what we are looking for from the consortia who will bid for the contract. Our green commitments are stated clearly in this brief.

Every section of the Design Brief is mirrored by an evaluation criterion linked to selection points. In order to win the contract bidders must address them all, including the environmental, ecological and global responsibility ones.

There is a specific criterion that requires the contractors to provide a minimum level of local community benefits, such as jobs and apprenticeships. It also incentivises them to provide further benefits which could include enhancements to the site for the benefit of the local community.

The Green vision in the Design Brief, which is given weight in the Evaluation Criteria, is then carried forward into contractual obligations.

The successful bidder will sign a Project Agreement with us which includes Authority Construction Requirements. These will reflect the range of Green requirements, and a Payment Mechanism which incentivises low use of energy.

Before applying for Outline Planning Permission for the new Velindre Cancer Centre, we commissioned a series of specialist consultants to assess all the possible environmental impacts and to propose mitigations to minimise them.

The proposals were articulated in the Environmental Statement, accepted by Cardiff City Council. They will be achieved through delivery of a Green Infrastructure Management Strategy, a Construction Environmental Management Plan and a Green Travel Plan.

These plans have to be approved by the council before construction starts. Delivery against them during the construction period is enforceable by the council under the terms of our planning permission. We will report publicly on progress.

All of this is underpinned by the Well-being of Future Generations Act.

Velindre University NHS Trust is one of the public bodies bound by the world-leading Well-being of Future Generations Act.

Under the Act, which was passed before we gained planning permission, we must develop the new Velindre Cancer Centre to achieve each of its seven goals. We are doing so in the following ways:

A healthier Wales - A society in which people's physical and mental well-being is maximised and in which choices and behaviours that benefit future health are understood.

- The new Velindre Cancer Centre will treat more people with cancer and help more people to live longer with cancer.
- It will use its surrounding beautiful environment to enhance patient experience, promote good mental health and minimise anxiety.
- It will enhance public access to the site and maximise community amenity and recreation.

A resilient Wales - A nation which maintains and enhances a biodiverse natural environment with healthy functioning ecosystems that support social, economic and ecological resilience and the capacity to adapt to change (for example climate change).

- The new Velindre Cancer Centre will protect local ecosystems and take up positive opportunities for improvement by improving biodiversity.
- The development will include action to protect air quality and minimise any negative impact of water drainage, noise and light.
- It will support more sustainable travel.

A globally responsible Wales - A nation which, when doing anything to improve the economic, social, environmental and cultural well-being of Wales, takes account of whether doing such a thing may make a positive contribution to global well-being.

- The new Velindre Cancer Centre will replace an old inefficient building with a modern energy efficient one, significantly reducing our carbon emissions.
- The design will be judged on how far its materials and operational practice impact on global warming.
- The operating contract for the centre's maintenance will require a challenging threshold of energy efficiency with incentives for further improvement.

A prosperous Wales - An innovative, productive and low carbon society which recognises the limits of the global environment and therefore uses resources efficiently and proportionately (including acting on climate change); and which develops a skilled and well-educated population in an economy which generates wealth and provides employment opportunities, allowing people to take advantage of the wealth generated through securing decent work.

- We are specifying low energy in the design and operation of the new Velindre Cancer Centre.
- We are incentivising the creation of local employment and apprenticeships.
- The new Velindre Cancer Centre will promote collaborative research and innovation.

WELLBEING OF FUTURE GENERATIONS

A Wales of cohesive communities - Attractive, viable, safe and well-connected communities.

- The new Velindre Cancer Centre will be welcoming and uplifting, providing space for the community inside and outside.
- It will improve on current access for the public on foot, by bicycle and by public transport.
- We aspire to a flagship building that will generate a sense of local pride and community.

A more equal Wales - A society that enables people to fulfil their potential no matter what their background or circumstances (including their socio economic background and circumstances).

- The new Velindre Cancer Centre will be accessible for all.

A Wales of vibrant culture and thriving Welsh language - A society that promotes and protects culture, heritage and the Welsh language, and which encourages people to participate in the arts, and sports and recreation.

- The new Velindre Cancer Centre will include space for art.
- It will maximise the use of the site for outdoor recreation.
- It will promote the area's heritage and culture.
- It will embrace and promote use of the Welsh language.



To deliver the commitments made in this document, Velindre is working with a number of 'special advisors', people with expertise and a proven track record of success in critical areas.

They have been tasked with pushing us 'that extra mile' to deliver on our vision and promises.

Our advisors include:

- **Phil Roberts** (Member of the Royal Institute of British Architects with an MSc in Environmental Architecture, former Independent Member of the Velindre University NHS Trust Board) - Consultant Design Adviser
- **Down to Earth** – A not-for-profit organisation specialising in community engagement, low carbon building and implementation of the Well-being of Future Generations Act
- **Simon Wright** - sustainable food production
- **Professor Phil Jones** (Welsh School of Architecture) - low and zero carbon design
- **Huw Denman** (Sylfaen Cyf) - tree planting and management, and ecological enhancement
- **Paddy Jenks** (Aderyn ecology) - ecology and species retention



Get involved

Please visit

www.transformingcancerservices.wales

to get involved in the design and development of the new Velindre Cancer Centre.

Velindre Cancer Centre, Velindre Road, Whitchurch, Cardiff, CF14 2TL.

Tel: 029 2061 5888



GIG
CYMRU
NHS
WALES

Ymddiriedolaeth GIG
Prifysgol Felindre
Velindre University
NHS Trust